

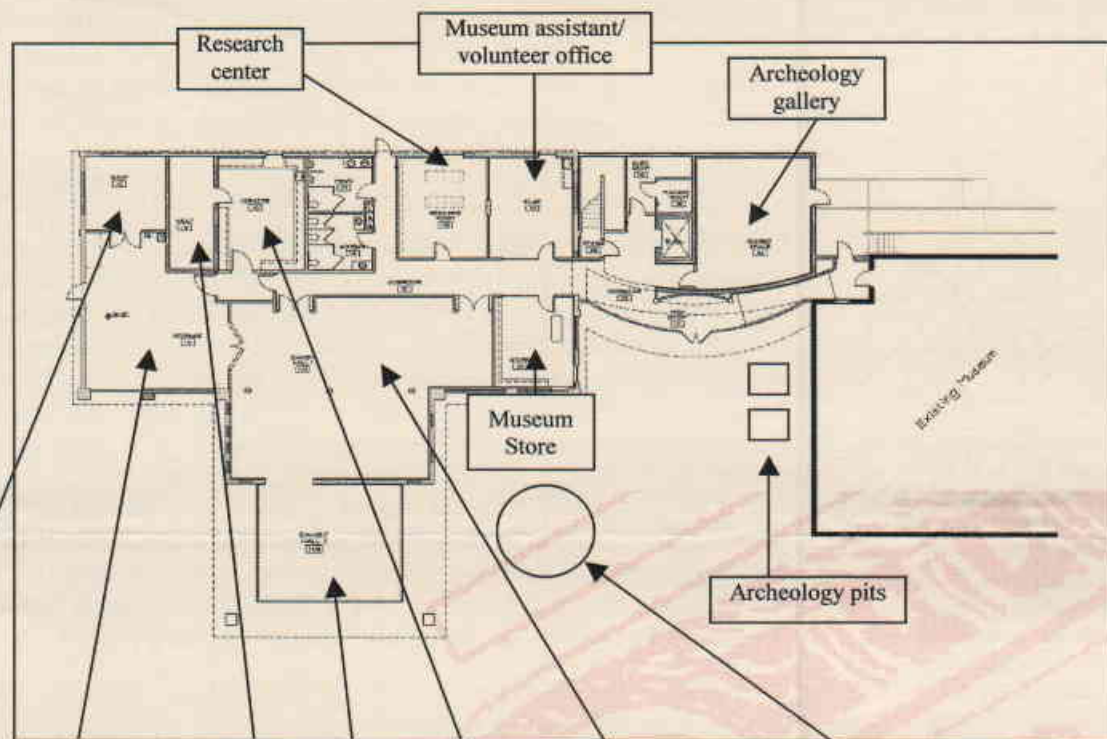

## Museum Musings

### Inside this issue:

- ❖ ¿Qué Pasa?
- ❖ Memberships, Memoria
- ❖ Log Cabin Mystery Solved
- ❖ Recent Acquisitions
- ❖ Goin' Up the Chisholm Trail – Monument



Carpentry shop; exhibit fabrication area

Area for exhibition crate and exhibition furniture storage; receiving area

Fireproof vault

1850s Little River log cabin

Curatorial office

Temporary/changing exhibition gallery

Tipi area

At long last . . . the Bell County Museum has much to celebrate!

*Recognizing that our past profoundly influences our future, the Bell County Museum collects, preserves and interprets the historical and cultural heritage of the Bell County region, for all citizens.*

*Our vision is of people from all walks of life, in all stages of life, being drawn to a welcoming place where they experience quality learning through the unique aspects of the museum setting; through that learning they become more engaged in their community, developing an appreciation of the collective experiences of those who have gone before, and passion to perpetuate those experiences to benefit those yet to come.*

Thanks to the generosity of our Capital Campaign contributors, Friends members, volunteers and myriad other supporters, we look forward to continuing to fulfill our mission and vision in this most unique and beautiful space.

## GOIN' UP THE CHISHOLM TRAIL - MONUMENT

Salado sculptor Troy Kelley has agreed to create our monument to the Chisholm Trail! The monument will consist of sixteen bronze panels produced in *bas-relief*. The panels will wrap around a column that is seventeen feet tall, with a bronze star at the top. Each panel will depict an event that occurred on the Chisholm Trail, naturally focusing on the many events that happened right here in Bell County. The panels, or bronze "storyboards," will move up the column, with the final panel depicting longhorns boarding a train in Abilene, Kansas. We anticipate that this work of art will not only successfully interpret the story of the Chisholm Trail, but will also provide a magnificent symbol for both the museum and the Bell County region. The monument should take about 16 months to complete.

## RECENT ACQUISITIONS

One of the museum's recent gifts is a collection of artifacts donated by the family of Dr. Raleigh and Allene Barr White III. The collection includes clothing, photographs, toys, and a logbook that dates from 1908-1918 from the Gulf, Colorado and Santa Fe Hospital. Also included in the gift are a child's World War I uniform (currently on exhibit), and a black mourning dress worn by Annie May Campbell White when her husband, Dr. Raleigh R. White, Jr., died suddenly on March 2, 1917. The dress still has the basting in the seams, indicating the quick construction of the garment.

Dr. White, Jr., along with Dr. Arthur Carroll Scott, formed the "fine-spirited partnership" that is today Scott & White Memorial Hospital and Clinic. Through the years, the White family has remained deeply rooted in Bell County; contributions by the family to improve the quality of life in the area and the state are too numerous to list here. We are grateful to the family for this important and well-documented donation.



We welcome Jodi Wright-Gidley as the museum's new Program Coordinator. Jodi served as curator for the museum from 1995-1998; she earned her master's degree in history from Sam Houston State University. We look forward to the great things she will do for the museum and the community.

## Log Cabin Mystery Solved

*Facts on the Little River log cabin:* it was built in the 1850s near Little River/Academy, the area of earliest settlement in Bell County, on land purchased in the 1950s by Dave Phillips; a house was built around it; the house and cabin were dismantled in October 1995 by Lonnie Edwards; the cabin was purchased by Grant Smith, and donated by him to the museum; Lonnie has reinstalled portions of the cabin at the museum.

*Mystery: Who built the cabin? Who lived in it?* Recent research by local historian and museum supporter Tom Heard reveals that the cabin was most likely constructed by and/or for John Leggett Marshall, an early Bell County pioneer and participant in the Battle of San Jacinto. Marshall was a blacksmith who assisted in cutting up pieces of iron, chains and horseshoes to make cannonballs for the Twin Sisters at the battle (Stephen L. Moore, *Eighteen Minutes*). As a child, Tom Heard's father pointed out the location of Marshall's cabin, and that of "Aunt Lucinda" Marshall. Five years ago, a distant relative of Marshall's confirmed the location of both residences. Both oral histories point to the same site, that of our log cabin site. Interestingly, a smithy was found on the property!

On loan to the museum by Tom is a rocker made by John Marshall's son-in-law, of bois d'arc wood. The chair may have at one time been in the original log cabin; Marshall's daughter Rachel Eugenia Marshall Heard brought it with her when she moved in with her father upon the early death of her first husband, the chair's maker.

*Please join us!* Take part in preserving the rich history of the Bell County region by joining the Friends of the Museum Association. Your membership allows us to continue award-winning programming through exhibits and educational activities that enhance our county-wide community. Benefits of membership include discounts in the museum bookstore, invitations to special events, and the satisfaction of knowing that YOU are an important part of the preservation of Bell County and Central Texas history. Together, we make our community great!

\_\_\_\_ Yes! I want to support the Bell County Museum by becoming a member of the Friends of the Museum Association.

\_\_\_\_ \$10 Student

\_\_\_\_ \$100 Patron

\_\_\_\_ \$25 Friend

\_\_\_\_ \$250 Partner

\_\_\_\_ \$50 Family

\_\_\_\_ \$500 Associate

\_\_\_\_ \$75 Advocate

\_\_\_\_ \$1,000+ Benefactor

## THANK YOU

TO OUR

### *New & Renewing Friends*

**Friend:**

Raye Virginia Allen  
 Mary O. Bowles  
 Enid & Jim Dickson  
 George Hester  
 David & Judy Hundley  
 Frances & Dr. John Idoux  
 Shanna & Tony Jeter  
 Sandy Mason  
 Miriam & Jack Oliver  
 Berneta Peeples  
 Becky Shulda

**Family:**

Dr. & Mrs. John Barton  
 Peggy & Jerry Bloomer  
 Connie & Bill Blowers  
 Mary & Frank Cannon  
 Hon. & Mrs. J.F. Clawson, Jr.  
 Kelvie Comer  
 Jon & Noelle Dula  
 Virginia & Sheryl Goodnight  
 Annette & Henry Lucksinger  
 Rebekah & Wade Matthews  
 Beata & George McLendon  
 Peggy & Vic Means  
 Dr. & Mrs. Robert Myers  
 Mr. & Mrs. Tom Popejoy  
 Sean Proctor  
 Aida & Wes Riddle  
 Nell & Bill Valigura  
 Jane & Mickey Wade

**Patron:**

Virginia Bennett  
 David Casto  
 Kathy & Ted Floca  
 Kathy & Griff Lord  
 Pat Shannon

**Associate:**

**Mickey & Bob Burtleson**

Mary & Dr. Will Long  
 Sel & Louise Nemer

## MEMORIALS

In memory of:

*Roy Adams*  
 by Sandy & Charles Collins

*Elbert Aldrich, Ila Bachus &  
 H.K. Allen*  
 by Wayne Bachus

*Dr. Ray Haywood*  
 by Mary Jean & Paul Boston

*Jim & Nan Russell*  
 by Betty Crowson

*John Shannon*  
 by Pat Shannon

*Mary Holland Vicknair*  
 by Mary Jean & Paul Boston

*Hollis C. Yeilding, Sr.*  
 by Bell County Judge &  
 Commissioners Court  
 Patty Benoit & Dr. Weldon Cannon  
 Mr. & Mrs. E.A. Limmer, Jr.  
 Stephanie Turnham



Thanks and appreciation go to Carol Macaulay, Bryan Jameson & Pearl Fellingham for their guidance, expertise, and installation of the museum's very cool archeology pits. The pits are designed for children to "excavate" an 1880s farmhouse and an Archaic hearth "site" on the museum.

We are grateful to the Railroad & Heritage Museum for transferring Native American reproduction items to our Education Collection. We will use the material in children's programs. Thank you to this wonderful institution and sister museum in Temple.

### *Big Bell County Garage Sale*

Proceeds: \$10,458.00! Hooray!

**A BIG thank you to all who helped**

made the event successful,  
 safe and fun

Bell County Museum

201 N. Main Street  
P.O. Box 1381  
Belton, TX 76513

Phone: 254.933.5243  
Fax: 254.933.5756  
Email: museum@co.bell.tx.us

PRSTD STD  
U.S. Postage  
**PAID**  
Permit No. 46  
Belton, TX 76513

**BELL COUNTY MUSEUM**  
Board of Trustees

Griff Lord, Chair

Dorothy Ann Aldrich	Jeannette Kelley
Mary Jean Boston	Sara Mackie
Bob Burlison	Sue Mayborn
Bill Clark	JoAn Musick-
Maryette Clifton	Flowers
Charlotte Douglass	John Odom
Roscoe Harrison	Helen Pickle

**Museum Staff**

Stephanie Turnham.....	Director
Amanda Thompson Dyer.....	Curator
Jodi Wright-Gidley.....	Program Coordinator
Candice Thaler.....	Assistant

**¿Qué Pasa?**

May 20, 2006 – Dedication Day for the New Wing

May 20 – August 12, 2006 – *Recovered Views: African American Portraits, 1912-1925*

May 20 – October 7, 2006 – *Building a Legacy: The E.A. Limmer, Jr. Collection*

June 8, 2006 – Belton Area Chamber of Commerce *Business After Hours* at the museum

June 15, 2006, 7:00 p.m. – Walking tour of Belton's downtown National Historic District, \$2 fee includes copy of the walking tour brochure

June 16, 2006 – *Evening For Our Friends*, 7:00 p.m.

July 6, 2006, 7:00 p.m. – Walking tour, \$2 fee

July 27, 2006, 7:00 p.m. – Walking tour, \$2 fee.